

<u>NAME</u>	<u>TRACT NO.</u>	<u>STATE</u>	<u>COUNTY</u>	<u>SEC</u>	<u>TWP</u>	<u>RNG</u>	<u>DESCRIPTION</u>	<u>ACTIVE WELL COUNT</u>	<u>WELL NAME</u>	<u>DECLINE MODEL</u>	<u>OGL</u>	<u>ROYALTY</u>	<u>NOTES</u>
<a href="#">Lambert Place</a>	1-A	Kansas	Barber	28	30S	15W	W/2 SW/4	0					
	1-B	Kansas	Barber	29	30S	15W	TRACT lying South of River in NW/4; S/2	0					Dry Hole drilled 1943 down to 4756'.
	1-C	Kansas	Barber	30	30S	15W	SE/4	0					
	1-D	Kansas	Barber	31	30S	15W	E/2 NE/4	0					
	1-E	Kansas	Barber	32	30S	15W	E/2; NW/4; N/2 SW/4; SE/4 SW/4	0					Dry Hole drilled 1990 down to 4695' (Viola).
	1-F	Kansas	Barber	33	30S	15W	W/2 NW/4	0					
<a href="#">Sutton Place</a>	2-A	Kansas	Barber	05	31S	15W	N/2 NW/4	0					Dry Hole drilled 1956 down to 4933' (Arbuckle).
	2-B	Kansas	Barber	33	30S	15W	SW/4; W/2 SE/4; W/2 NE/4	1	<a href="#">Ray Moad No. 2</a>	<a href="#">LINK</a>	167/227	.125	Cumulative production on a lease basis; Also includes Ray Moad 1 well spud 3/18/1980, last produced in 1995, plugged on 11/11/2015.
<a href="#">Wauneeta G. Riepe Place</a>	3-A	Kansas	Barber	27	30S	15W	NW/4 SW/4	0					Dry Hole drilled 1969 down to 4616' (Miss).
	3-B	Kansas	Barber	28	30S	15W	NE/4 (lying SW of RR); SW/4 NW/4; E/2 SW/4; N/2 SE/4	0					Dry Holes (2) drilled in 1963 down to 4693' (Arbuckle) and drilled in 1966 down to 4443' (Viola). Gas Well drilled in 1980 down to 4600' (Viola). Plugged 8/24/1981.
<a href="#">Kenneth Riepe Place</a>	4-A	Kansas	Barber	27	30S	15W	SW/4 SW/4	0					
	4-B	Kansas	Barber	28	30S	15W	S/2 SE/4	0					Expired intent to drill from 1981.
<a href="#">Gypsum Valley Place</a>	5-A	Kansas	Barber	03	31S	15W	L3; L4; W/2 SW/4; S/2 NW/4	0					Dry Hole drilled 1967 down to 4594' (Simpson).
	5-B	Kansas	Barber	04	31S	15W	ALL	2	<a href="#">Lenkner 1</a>	<a href="#">LINK</a>	171/441 183/11	.125	Cumulative production on a lease basis; Includes Lenkner 1 and Lenkner 'B' 1. Dry Holes (5) drilled in 1962 (1) down to 4851' (Arbuckle) and the early 1980s (4) down to the Viola and Arbuckle (4570'-4800').
									<a href="#">Lenkner B 1</a>				
	5-C	Kansas	Barber	09	31S	15W	N/2	0					
	5-D	Kansas	Barber	10	31S	15W	N/2 NW/4	0					
<a href="#">Mills Place</a>	6-A	Kansas	Barber	34	30S	15W	S/726' of NE/4; S/726' of E/2 NW/4; E/2 SW/4; SE/4	0					Dry Hole drilled in 1966 down to 4572' (Viola).
	6-B	Kansas	Barber	35	30S	15W	NW/4; W/2 SW/4	0					Dry Hole drilled in 1942 down to 4346'. Oil Wells (3) drilled in early 1940s down to Kansas City Group (and below). All Plugged in 1965.
<a href="#">Packard Place</a>	7-A	Kansas	Barber	21	30S	15W	S/2 SW/4	0					
	7-B	Kansas	Barber	28	30S	15W	N/2 NW/4; SE/4 NW/4, L/E 0.03ac tract	0					
<a href="#">Peoples Bank/Freeman Place</a>	8-A	Kansas	Barber	34	30S	15W	ATP NE/4 & E/2 NW/4 (lying S of River Road), L/E S/726' thereof	0					Dry Hole drilled in 1946 down to 4451' (Viola).
	8-B	Kansas	Barber	27	30S	15W	ATP E/2 SW/4 (lying S of River Road)	0					
<a href="#">J.T. March Ranch Place</a>	9-A	Kansas	Barber	22	30S	15W	S/2	0					Dry Holes (3) drilled in 1940s (2) down to the Kansas City (4445') and Viola (4590') and drilled in 1959 (1) down to 4608' (Viola). Oil Wells (5) drilled in the 1940s (1) and 1950s (4) down to the Viola (4) and Kansas City (1). Plugged in the 1960s.
	9-B	Kansas	Barber	26	30S	15W	NW/4	0					Dry Holes (3) drilled in 1943 (1) down to 4718' (Simpson), drilled in 1946 (1) down to 4324' (Kansas City), drilled in 1994 (1) down to 4760' (Arbuckle).
	9-C	Kansas	Barber	27	30S	15W	N/2; SE/4; E/2 SW/4, L/E ATP lying S of River Road	0					Dry Holes (6) drilled in the 1940s (1) and 1950s (1) down to the Kansas City Group (4344'-4480'). Oil Wells (5) drilled in the 1940s (2) down to the Miss and Viola, the 1950s (2) down to the Lansing and Kansas City, 1977 (1) down to 4550' (Viola). Plugged in the 1960s (4) and 1983 (1).
	9-D	Kansas	Barber	34	30S	15W	ATP NE/4 lying N of River Road	0					Oil Well drilled in 1946 down to 4305' (Kansas City). Plugged in 1965.

SUBJECT PROPERTY:

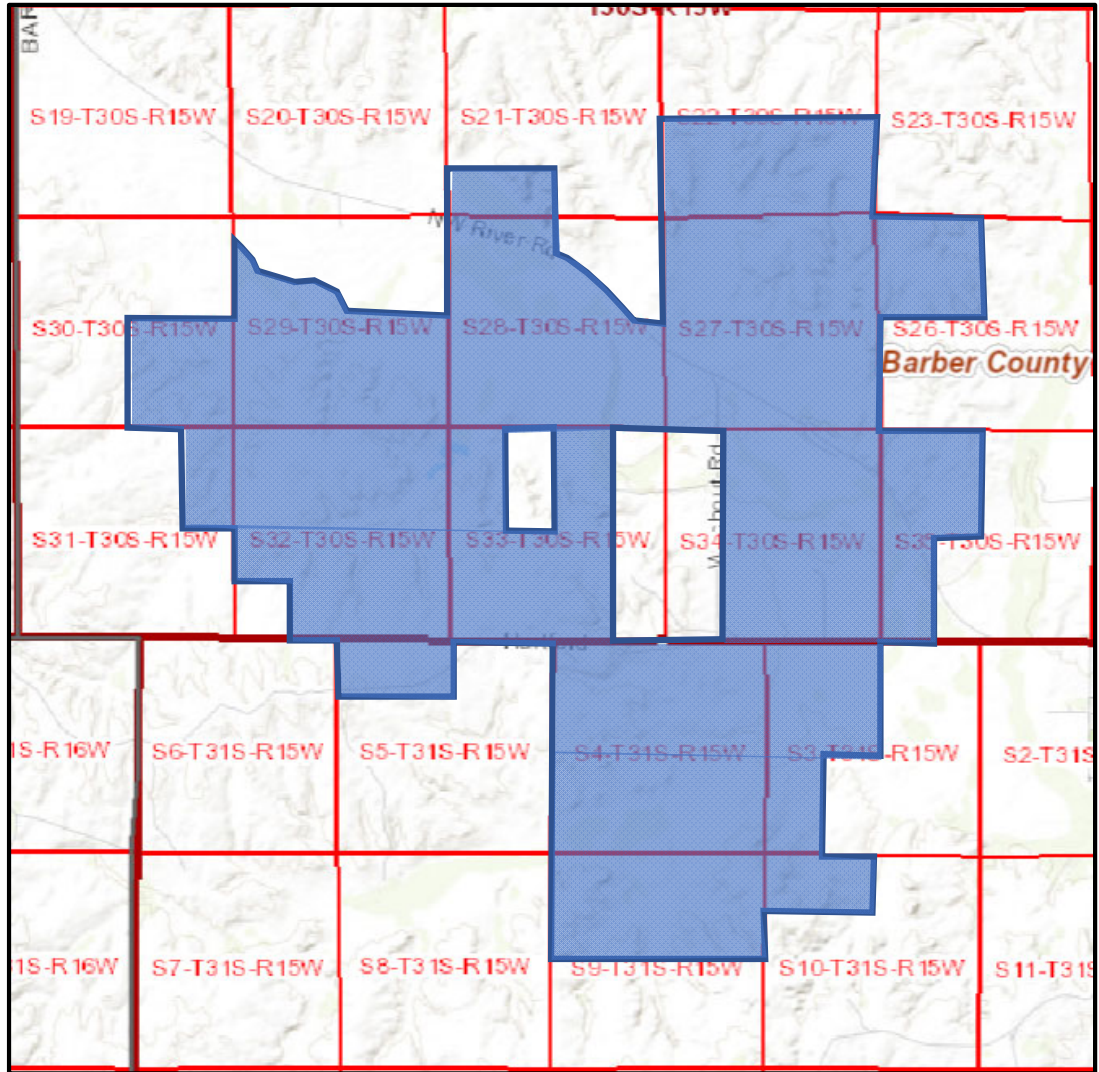

SUBJECT PROPERTY WITH FIELDS:

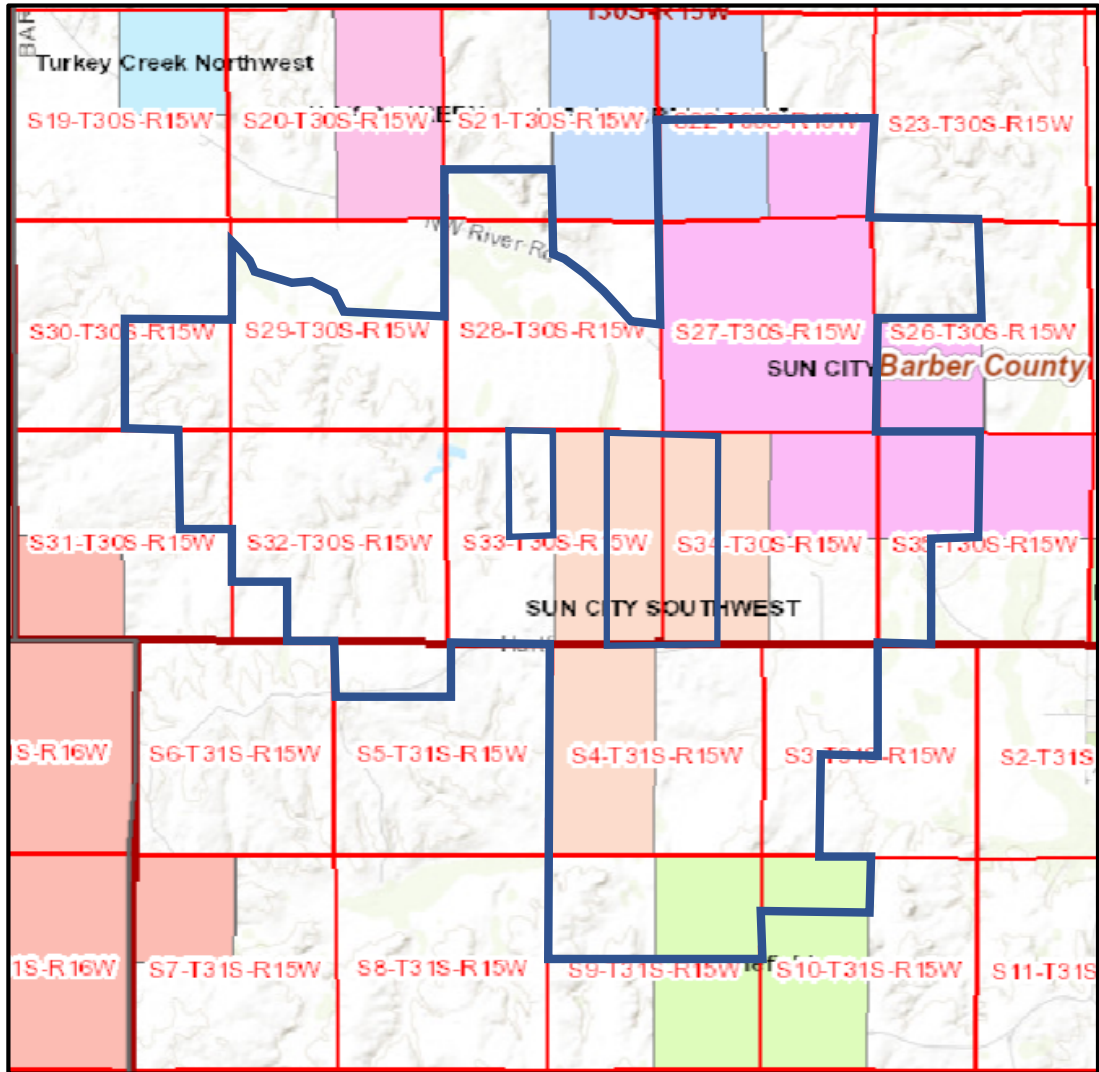

**SUBJECT PROPERTY WITH FIELDS/WELLS:**

**Legend**

- ◊ Dry and Abandoned
- ⚡ Enhanced Oil Recovery
- ⚡ Enhanced Oil Recovery, Plugged-Abandoned
- ☀ Gas
- ☀ Gas, Plugged-Abandoned
- ⚡ Injection
- ⚡ Injection, Plugged-Abandoned
- Intent
- Location
- ⚡ Oil and Gas
- ⚡ Oil and Gas, Plugged-Abandoned
- Oil
- ⚡ Oil, Plugged-Abandoned
- ⊙ Other
- ⊙ Other, Plugged-Abandoned

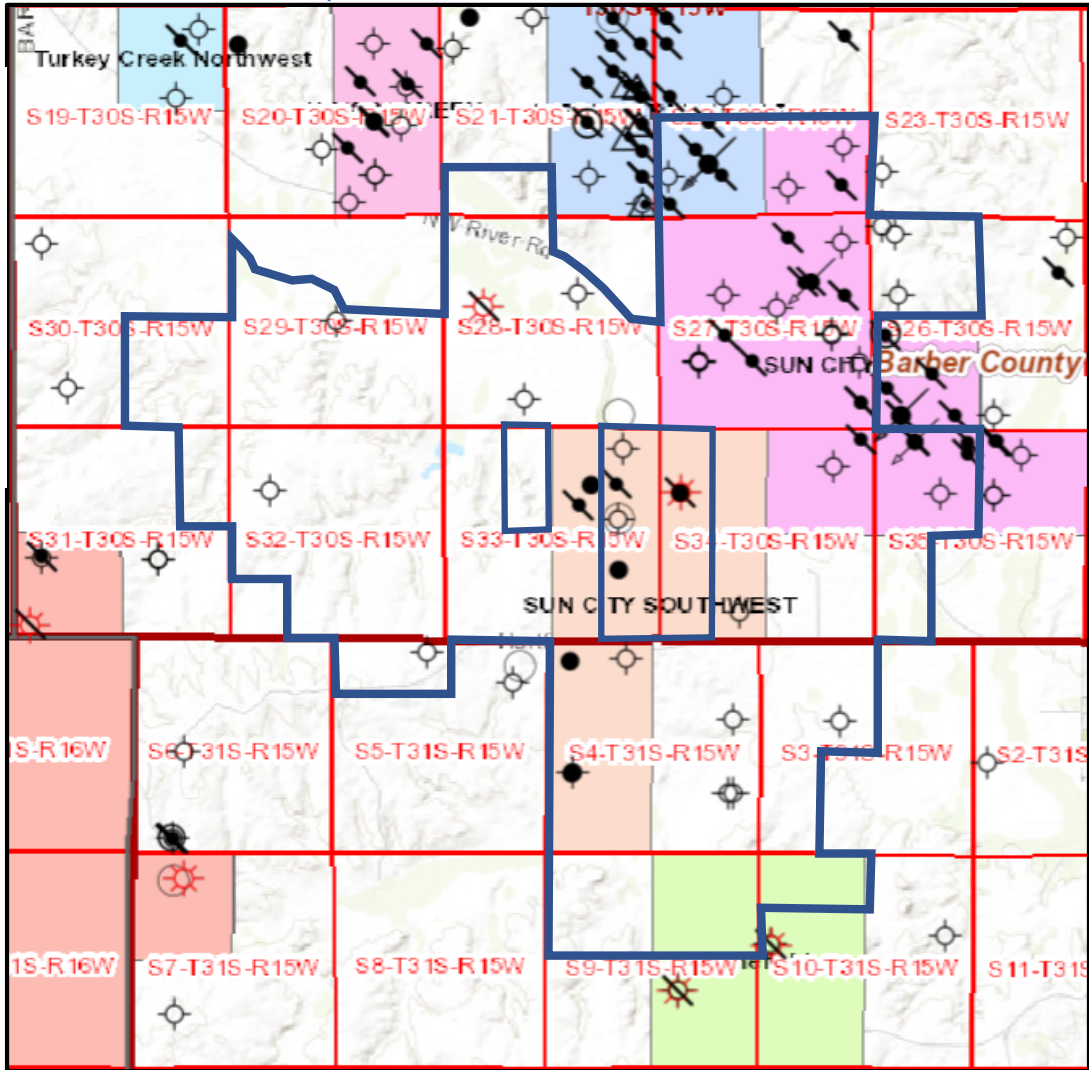

LAMBERT:

### Legend

-  Dry and Abandoned
-  Enhanced Oil Recovery
-  Enhanced Oil Recovery, Plugged-Abandoned
-  Gas
-  Gas, Plugged-Abandoned
-  Injection
-  Injection, Plugged-Abandoned
-  Intent
-  Location
-  Oil and Gas
-  Oil and Gas, Plugged-Abandoned
-  Oil
-  Oil, Plugged-Abandoned
-  Other
-  Other, Plugged-Abandoned

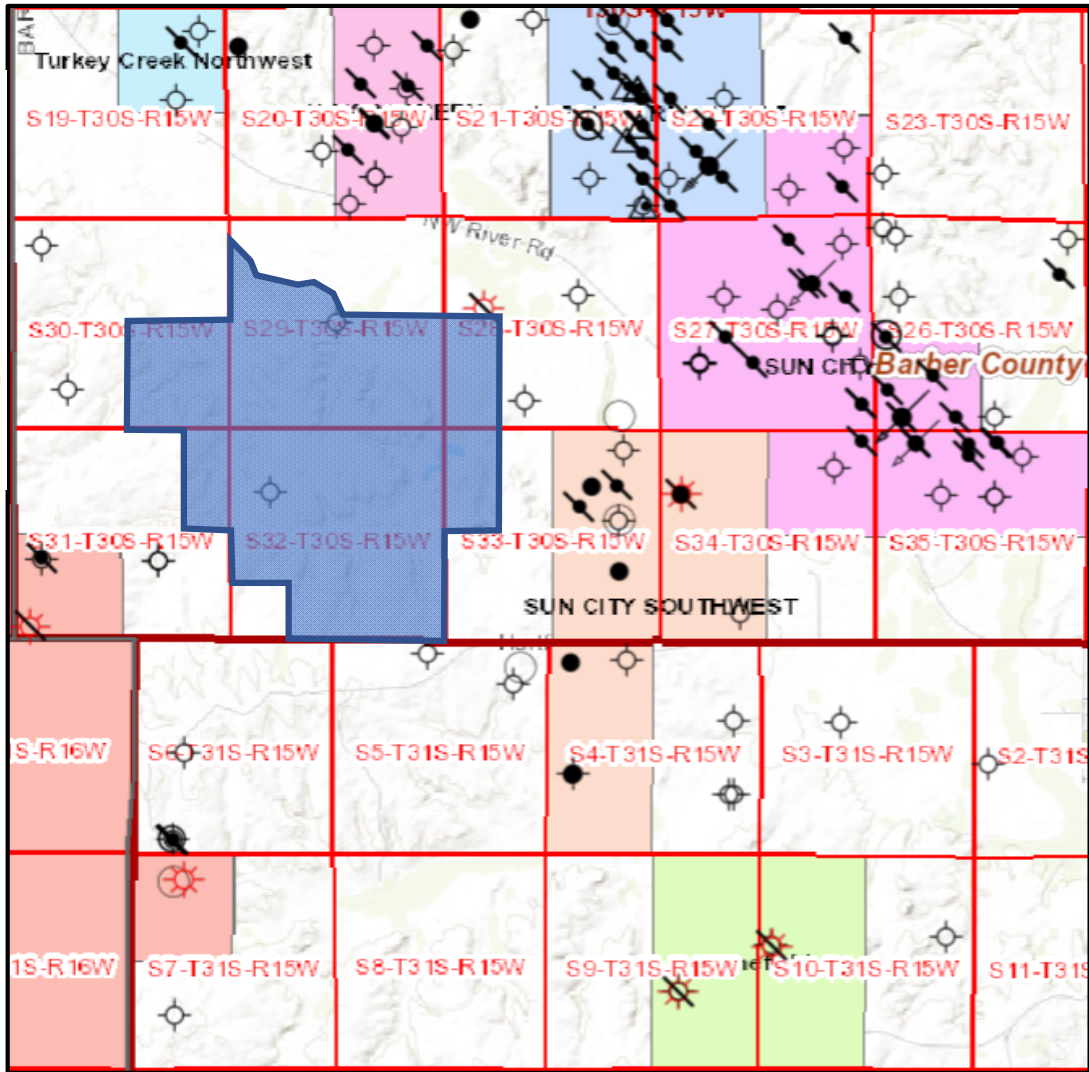

SUTTON:

Legend

-  Dry and Abandoned
-  Enhanced Oil Recovery
-  Enhanced Oil Recovery, Plugged-Abandoned
-  Gas
-  Gas, Plugged-Abandoned
-  Injection
-  Injection, Plugged-Abandoned
-  Intent
-  Location
-  Oil and Gas
-  Oil and Gas, Plugged-Abandoned
-  Oil
-  Oil, Plugged-Abandoned
-  Other
-  Other, Plugged-Abandoned

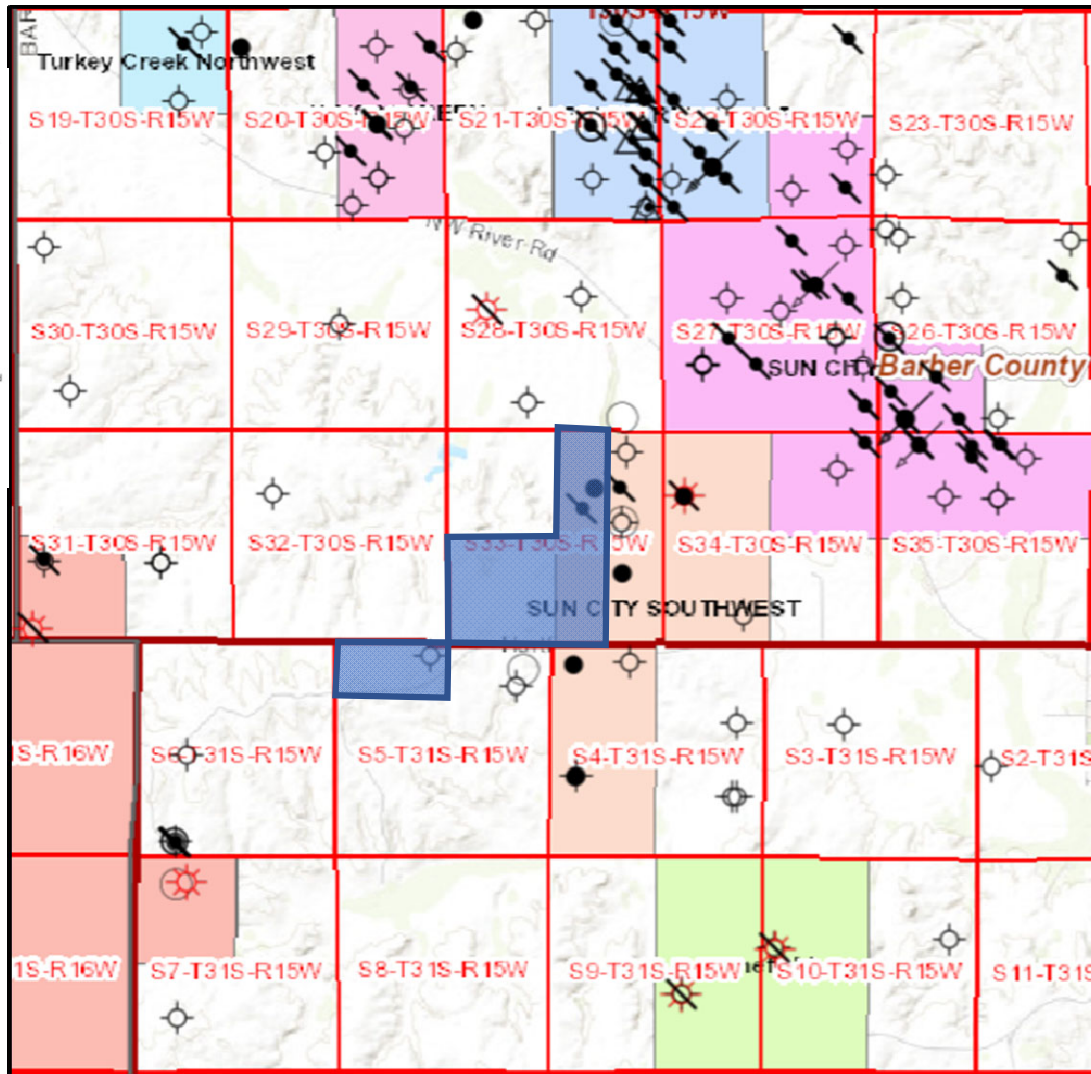

W.G. RIEPE:

### Legend

-  Dry and Abandoned
-  Enhanced Oil Recovery
-  Enhanced Oil Recovery, Plugged-Abandoned
-  Gas
-  Gas, Plugged-Abandoned
-  Injection
-  Injection, Plugged-Abandoned
-  Intent
-  Location
-  Oil and Gas
-  Oil and Gas, Plugged-Abandoned
-  Oil
-  Oil, Plugged-Abandoned
-  Other
-  Other, Plugged-Abandoned

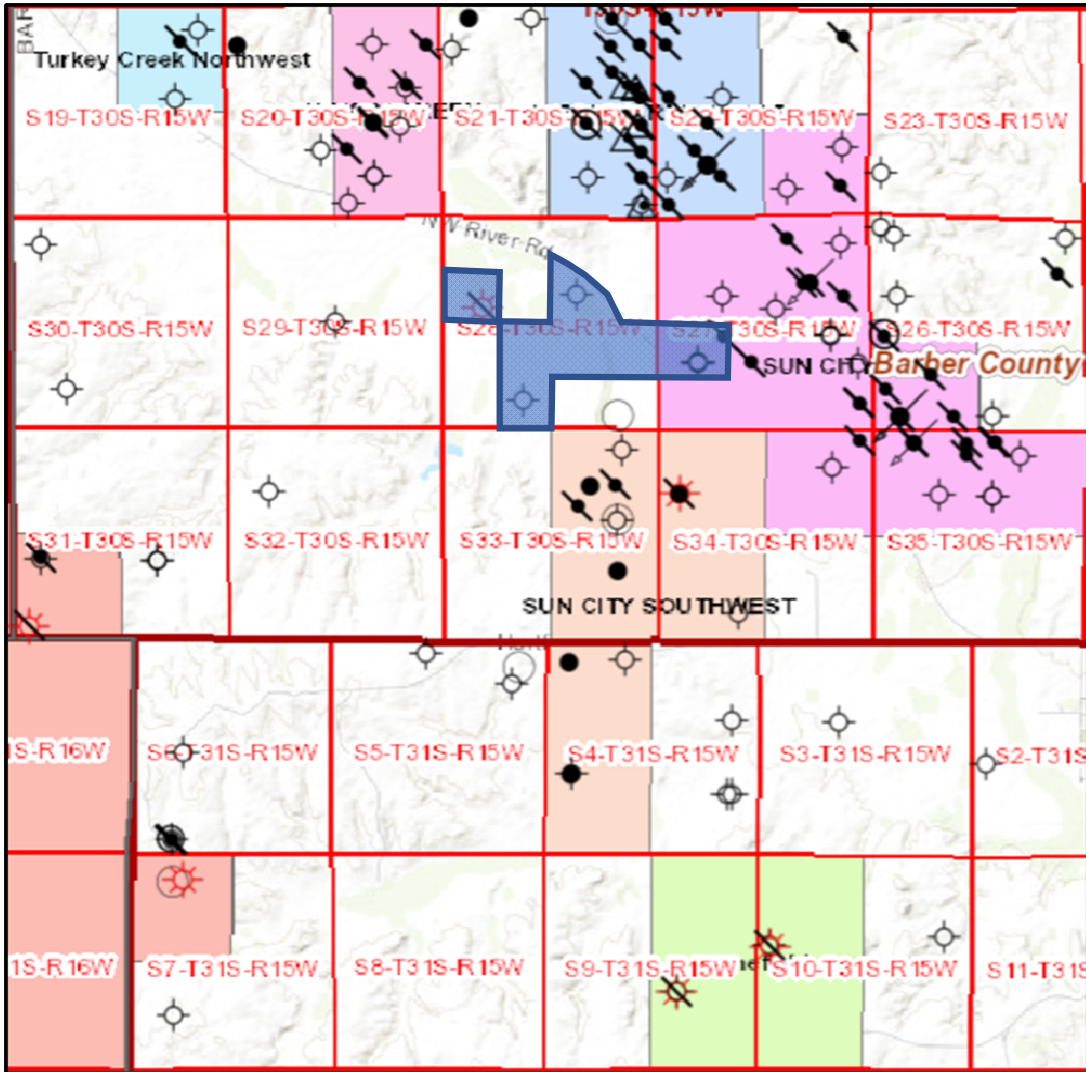

K. RIEPE:

Legend

- Dry and Abandoned
- Enhanced Oil Recovery
- Enhanced Oil Recovery, Plugged-Abandoned
- Gas
- Gas, Plugged-Abandoned
- Injection
- Injection, Plugged-Abandoned
- Intent
- Location
- Oil and Gas
- Oil and Gas, Plugged-Abandoned
- Oil
- Oil, Plugged-Abandoned
- Other
- Other, Plugged-Abandoned

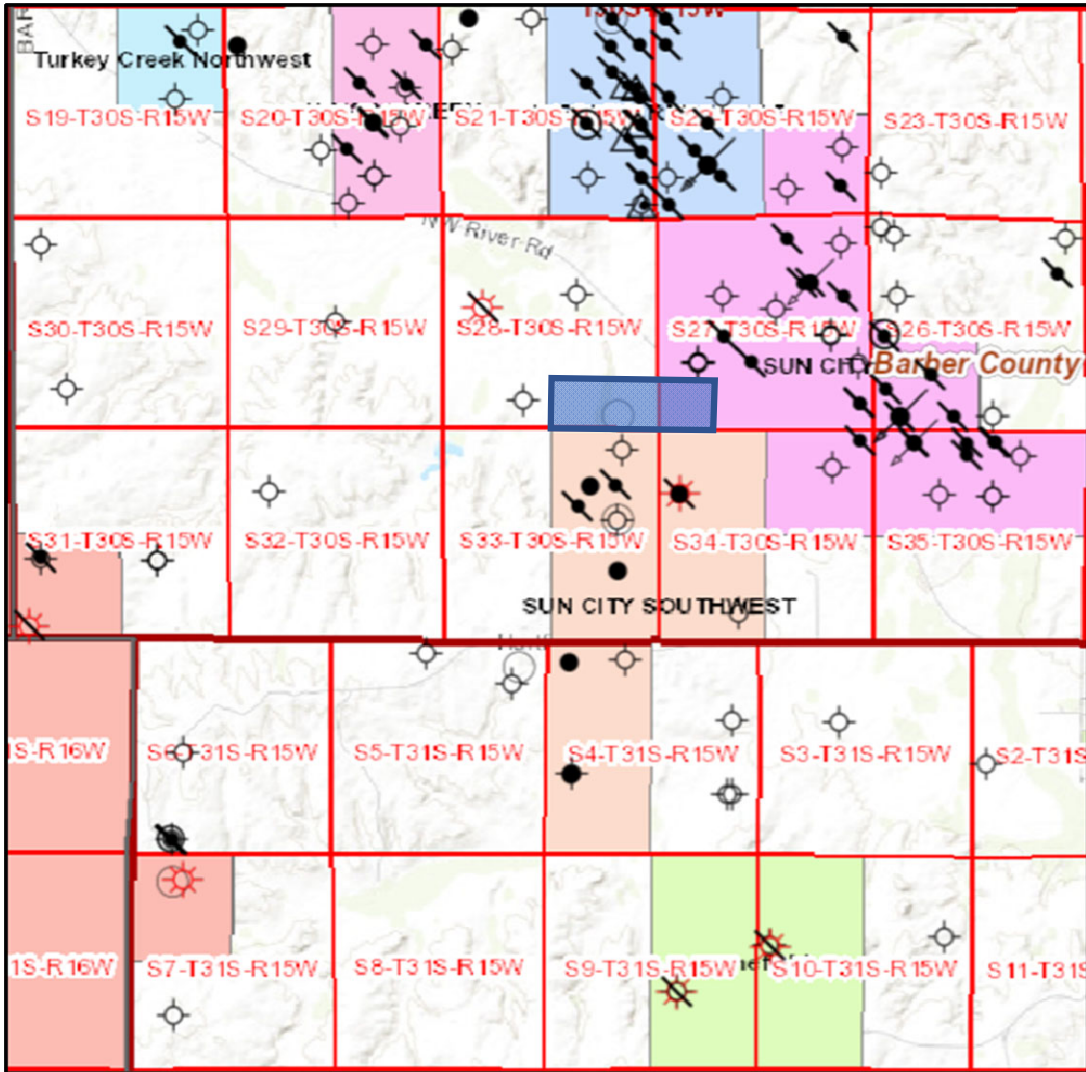



**GYPSUM VALLEY:**

**Legend**

-  Dry and Abandoned
-  Enhanced Oil Recovery
-  Enhanced Oil Recovery, Plugged-Abandoned
-  Gas
-  Gas, Plugged-Abandoned
-  Injection
-  Injection, Plugged-Abandoned
-  Intent
-  Location
-  Oil and Gas
-  Oil and Gas, Plugged-Abandoned
-  Oil
-  Oil, Plugged-Abandoned
-  Other
-  Other, Plugged-Abandoned

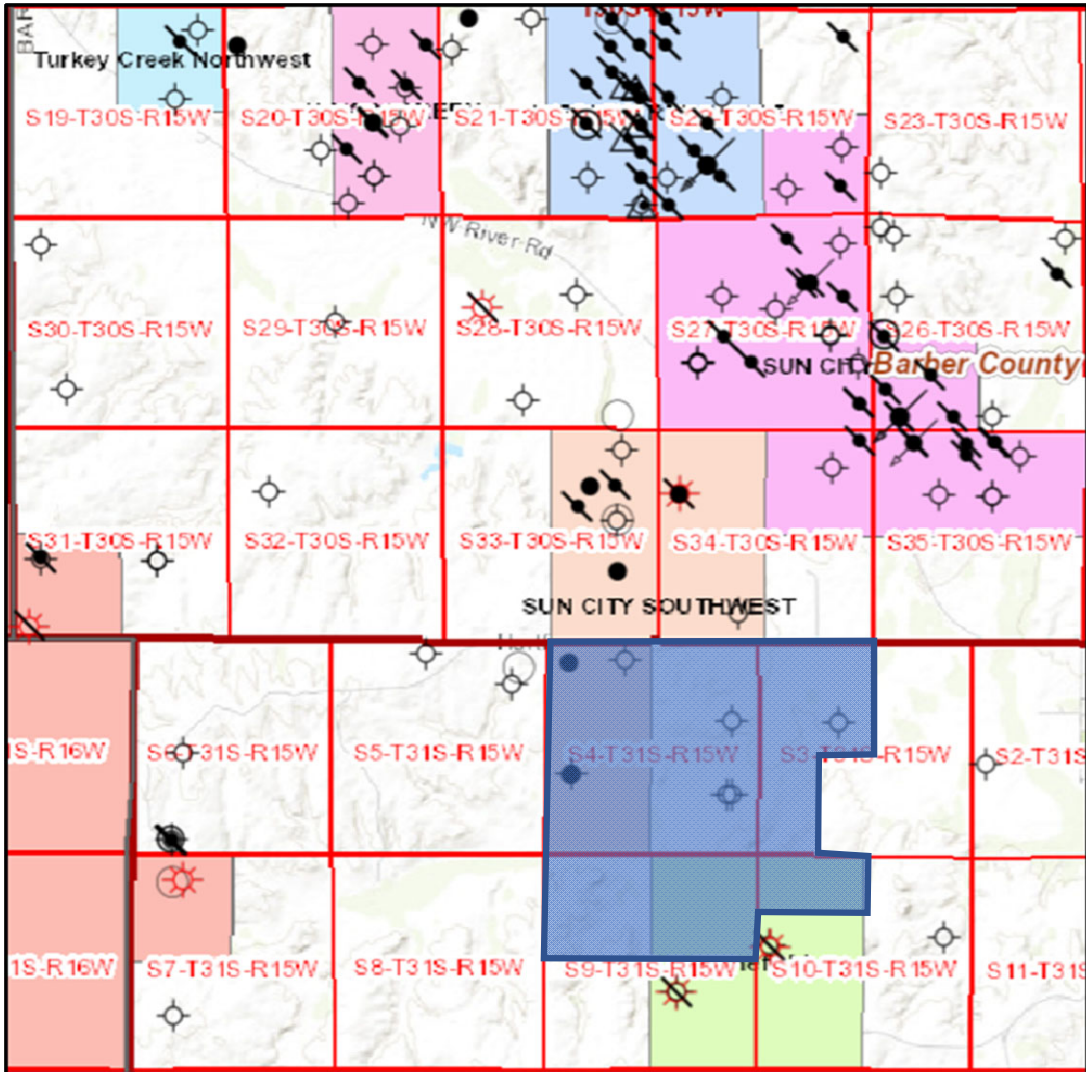

MILLS:

Legend

- ◇ Dry and Abandoned
- Enhanced Oil Recovery
- ⊗ Enhanced Oil Recovery, Plugged-Abandoned
- ⊗ Gas
- ⊗ Gas, Plugged-Abandoned
- ⊗ Injection
- ⊗ Injection, Plugged-Abandoned
- Intent
- Location
- ⊗ Oil and Gas
- ⊗ Oil and Gas, Plugged-Abandoned
- Oil
- ⊗ Oil, Plugged-Abandoned
- ⊗ Other
- ⊗ Other, Plugged-Abandoned

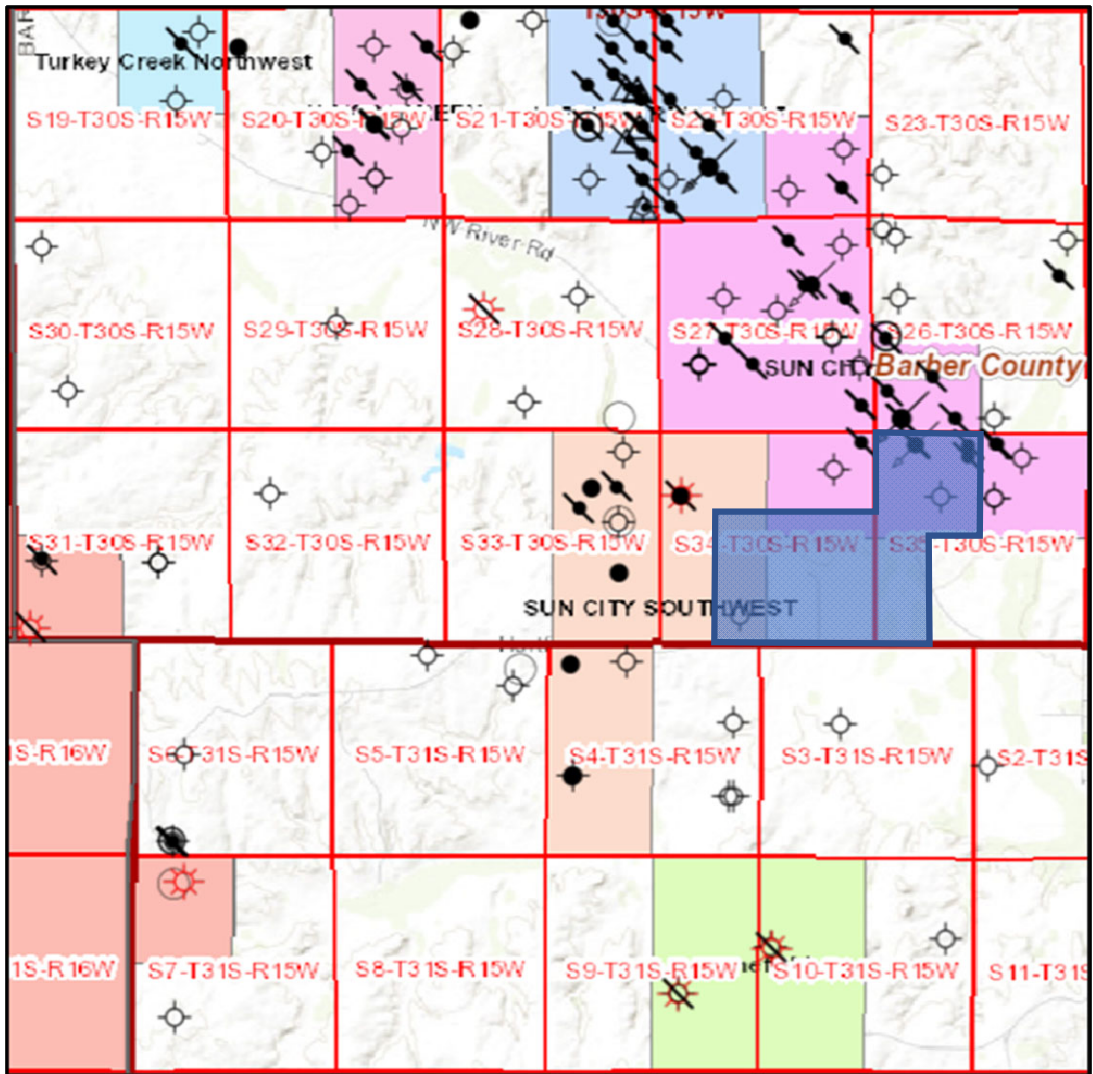

PACKARD:

Legend

-  Dry and Abandoned
-  Enhanced Oil Recovery
-  Enhanced Oil Recovery, Plugged-Abandoned
-  Gas
-  Gas, Plugged-Abandoned
-  Injection
-  Injection, Plugged-Abandoned
-  Intent
-  Location
-  Oil and Gas
-  Oil and Gas, Plugged-Abandoned
-  Oil
-  Oil, Plugged-Abandoned
-  Other
-  Other, Plugged-Abandoned

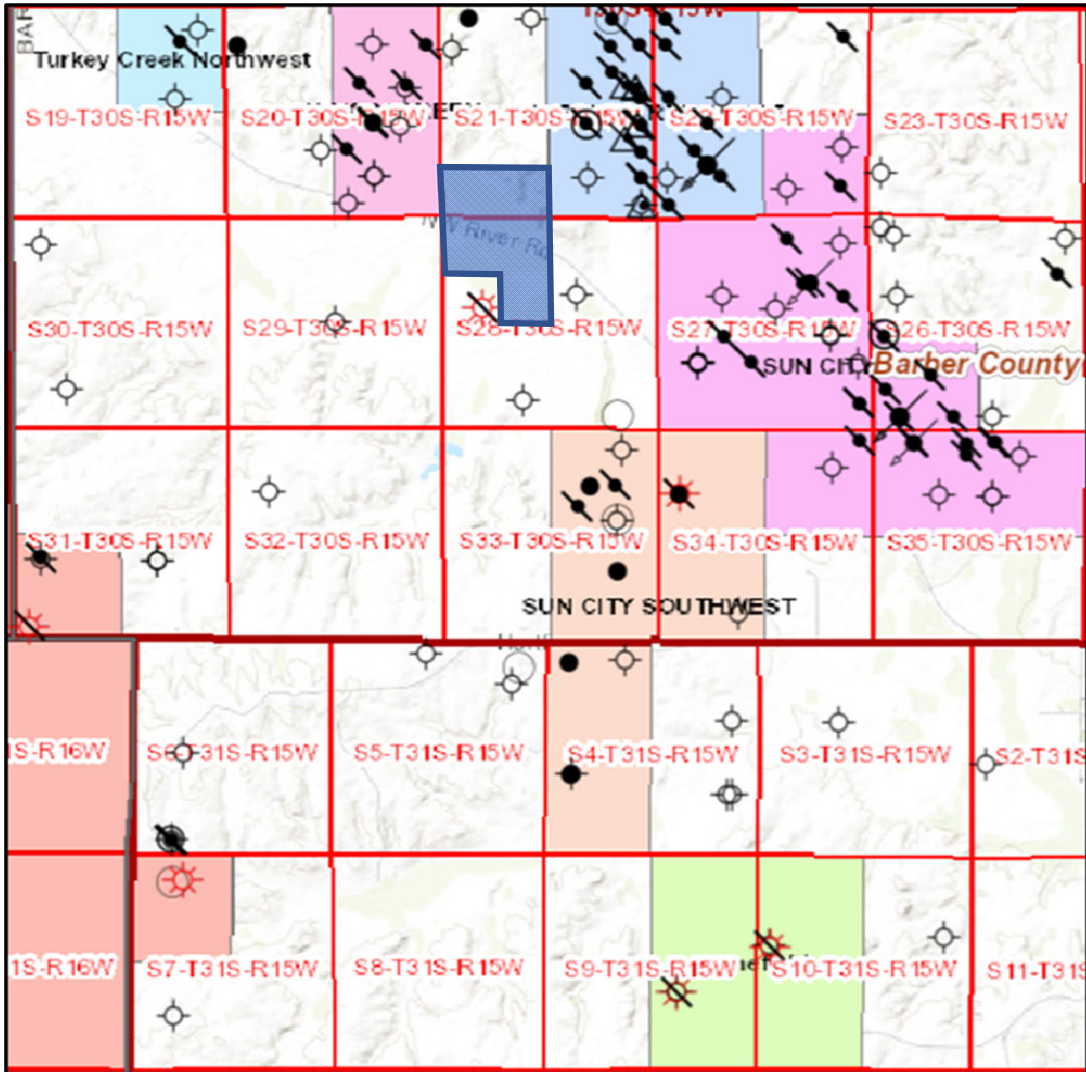

PEOPLES BANK/FREEMAN:

Legend

- ◊ Dry and Abandoned
- Enhanced Oil Recovery
- ✂ Enhanced Oil Recovery, Plugged-Abandoned
- ☀ Gas
- ✂ Gas, Plugged-Abandoned
- ⊙ Injection
- ✂ Injection, Plugged-Abandoned
- Intent
- Location
- ✂ Oil and Gas
- ✂ Oil and Gas, Plugged-Abandoned
- Oil
- ✂ Oil, Plugged-Abandoned
- ⊙ Other
- ✂ Other, Plugged-Abandoned

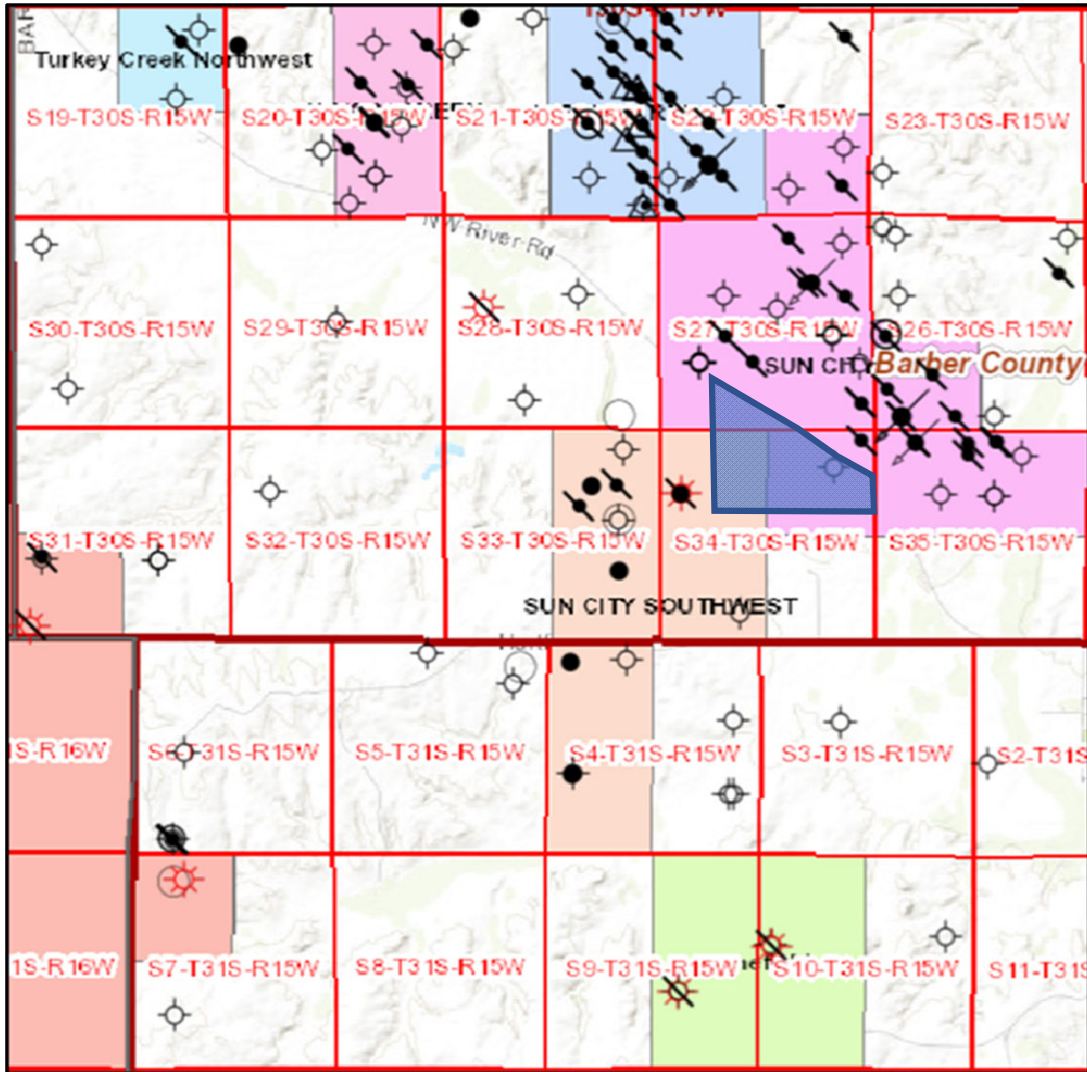

J.T. MARCH:

### Legend

-  Dry and Abandoned
-  Enhanced Oil Recovery
-  Enhanced Oil Recovery, Plugged-Abandoned
-  Gas
-  Gas, Plugged-Abandoned
-  Injection
-  Injection, Plugged-Abandoned
-  Intent
-  Location
-  Oil and Gas
-  Oil and Gas, Plugged-Abandoned
-  Oil
-  Oil, Plugged-Abandoned
-  Other
-  Other, Plugged-Abandoned

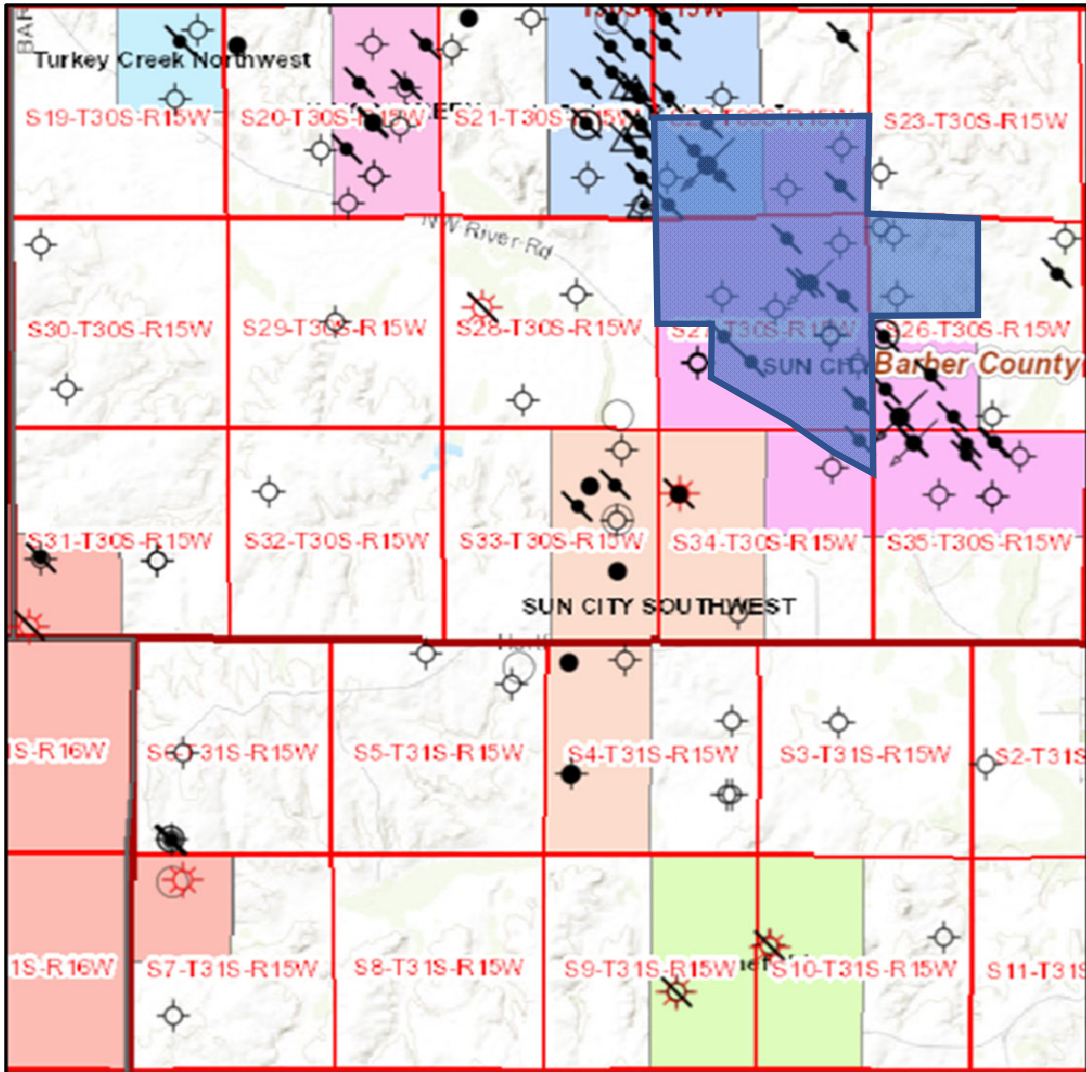

<u>WELL NAME</u>	<u>API</u>	<u>WELL CLASSIFICATION</u>	<u>SPUD DATE</u>	<u>FIELD</u>	<u>PRODUCING FORMATION</u>	<u>OPERATOR</u>	<u>LAST REPORTED PRODUCTION</u>	<u>CUMULATIVE OIL</u>	<u>CUMULATIVE GAS</u>	<u>CUMULATIVE BOE</u>	<u>LAST MONTH OIL</u>	<u>LAST MONTH GAS</u>	<u>DECLINE MODEL</u>	<u>NOTES</u>
<a href="#">Ray Moad No. 2</a>	15-007-21088	Oil	1/11/1981	Sun City Southwest	Marmaton, Misener	Murjo Oil & Royalty Co.	02/2020	87544.21	N/A	N/A	161.76	N/A	<a href="#">LINK</a>	Cumulative production on a lease basis; Also includes Ray Moad 1 well spud 3/18/1980, last produced in 1995, plugged on 11/11/2015.
<a href="#">Lenkner 1</a>	15-007-21071	Oil	12/15/1980	Sun City Southwest	Fort Scott	Prater Oil & Gas Operations, Inc.	11/2019	44914.33	N/A	N/A	160.64	N/A	<a href="#">LINK</a>	Cumulative production on a lease basis; Includes Lenkner 1 and Lenkner 'B' 1.
<a href="#">Lenkner B 1</a>	15-007-0098-0001	Oil	2/25/1982	Sun City Southwest	Fort Scott	Prater Oil & Gas Operations, Inc.								Dry Holes (5) drilled in 1962 (1) down to 4851' (Arbuckle) and the early 1980s (4) down to the Viola and Arbuckle (4570'-4800').

CARDS MUST  
BE TYPED

STATE OF KANSAS  
NOTICE OF INTENTION TO DRILL

C-1  
MI-1331

TO BE FILED WITH THE STATE CORPORATION COMMISSION  
5 DAYS PRIOR TO COMMENCEMENT OF WELL

API Number 15- 007-21,088-00-00  
(For office use only)

1. Operator MURJO OIL & ROYALTY CO.  
Address 2525 Ridgmar Rd. (P.O. Box 12666)  
City-State Ft. Worth, TX Zip Code 76116

Starting Date 1 / 10 / 81  
Month Day Year

County Barber

2. Contractor H-30, INC.  
Address 251 N. Water, Ste. 10  
City-State Wichita, KS Zip Code 67202

Sec. 33 Twp. 30 S. Rng. 15 ~~East~~ West

Exact Spot Location of Well 1650' FNL & 1650' FEL

- 3. Type of Equipment: Rotary:  Air: \_\_\_\_\_ Cable Tools: \_\_\_\_\_
- 4. Well to be Drilled for: Oil:  Gas:  SWD: \_\_\_\_\_ Input: \_\_\_\_\_
- 5. Well Classification: Infield \_\_\_\_\_ Pool Ext.  Wildcat \_\_\_\_\_
- 6. Depth of Deepest Fresh Water within 1 mile 50 ft.
- 7. Depth of Municipal Water Well within 3 miles NONE ft.
- 8. Depth to Protect all Fresh Water (Table 1) 200 ft.
- 9. Amount of Surface Casing to be set OVER 250 ft.
- 10. (Surface Casing) Alternate No. 1 \_\_\_\_\_ Alternate No. 2 \_\_\_\_\_

Nearest Lease Line 990'

Lease Name RAY MOAD

Well No. 2

Est. Total Depth 4,900 ft.

\$40.00 FEE PAID  1-5-81  
REMARKS: AC# 23014

OPERATOR/STATES THAT HE WILL COMPLY WITH K.S.A. 55-128

Signature of Operator [Handwritten Signature]

JAN 5 1981  
1-5-81  
307  
WICHITA, KANSAS

First  
Class  
Postage

**State Corporation Commission of Kansas  
Conservation Division  
245 North Water  
Wichita, Kansas 67202**

**(IF PREFERRED, MAIL IN ENVELOPE)**



Lease: RAY MOAD #2

Operator: Murjo Oil & Royalty Company

Location: C SW NE T30S, R15W, Sec. 33

Cumulative Production: 87544.21 barrels (from 1980 to 2020)

KS Dept. of Revenue Lease Code: 113538

KS Dept. of Revenue Lease Name: RAY MOAD #2

Adjust the Years Displayed

Start Year: 1980

End Year: 2020

Adjust Plot

Initial production monthly rate (Qi): 52 bbls in 2017

Present production monthly rate (Qt): 27 bbls in 2019

Decline rate (De): 23.9968% per year

Exponential K: .02724179

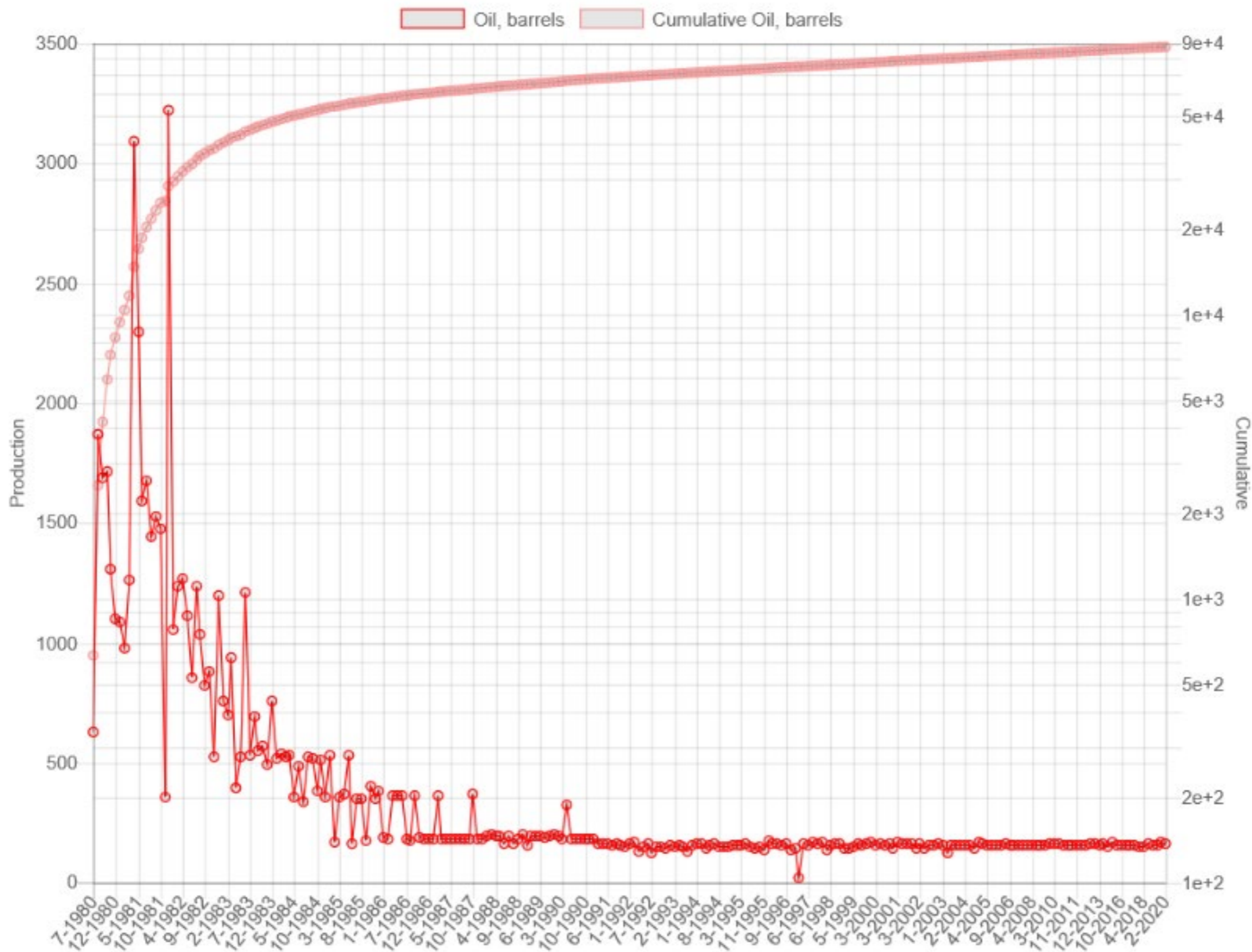

**Lease:** RAY MOAD #2  
**Operator:** Murjo Oil & Royalty Company  
**Location:** C SW NE T30S, R15W, Sec. 33  
**Cumulative Production:** 87544.21 barrels (from 1980 to 2020)  
**KS Dept. of Revenue Lease Code:** 113538  
**KS Dept. of Revenue Lease Name:** RAY MOAD #2  
**Field:** [Sun City Southwest](#)  
**County:** Barber  
**Producing Zone:** Marmaton, Misener  
**Well Data (may be an incomplete list):**

<a href="#">T30S R15W, Sec. 33, NW NE SW NE</a> <b>Lease:</b> RAY MOAD 2 <b>Operator:</b> MURJO OIL-ROYALTY <b>Current Operator:</b> Murjo Oil & Royalty Company <b>API Number:</b> 15-007-21088	<a href="#">T30S R15W, Sec. 33, SW NE</a> <b>Lease:</b> RAY MOAD 1 <b>Operator:</b> XPLOR DRILLING CO. <b>Current Operator:</b> Murjo Oil & Royalty Company <b>API Number:</b> 15-007-20890
--	---

Data are received monthly from the Kansas Department of Revenue.

### Annual Oil Production, (bbls)

Please Note: New Prototype charting system.

Year	Production	Wells
2000	816	1
2001	954	1
2002	785	1
2003	755	1
2004	633	1
2005	638	1
2006	627	1
2007	476	1
2008	317	1
2009	476	1
2010	485	1
2011	470	1
2012	318	1
2013	484	1
2014	315	1
2015	323	1
2016	160	1
2017	623	1
2018	474	1
2019	324	1
2020	162	1

Year	Production	Wells
1980	8,316	1
1981	16,796	2
1982	14,465	2
1983	8,129	2
1984	5,609	2
1985	4,141	2
1986	2,749	2
1987	2,383	2
1988	1,886	2
1989	1,336	2
1990	1,808	2
1991	1,109	2
1992	1,353	2
1993	903	2
1994	1,396	2
1995	1,060	2
1996	954	1
1997	815	1
1998	790	1
1999	933	1

Updated through 2-2020.

Note: bbls is barrels; mcf is 1000 cubic feet.

### Recent Monthly Oil Production, (bbls)

(Complete production available in file saved using blue button at top of page.)

Year	Month	Production	Wells	Reporter or Purchaser/ Reporting Customer
2014	4	163.95	1	<a href="#">PLAINS MARKETING L.P. (100%)</a>
2014	9	151.54	1	<a href="#">PLAINS MARKETING L.P. (100%)</a>
2015	2	166.6	1	<a href="#">PLAINS MARKETING L.P. (100%)</a>
2015	8	155.94	1	<a href="#">PLAINS MARKETING L.P. (100%)</a>
2016	10	159.97	1	<a href="#">PLAINS MARKETING L.P. (100%)</a>
2017	1	157.27	1	<a href="#">PLAINS MARKETING L.P. (100%)</a>
2017	5	157.05	1	<a href="#">PLAINS MARKETING L.P. (100%)</a>
2017	9	155.91	1	<a href="#">PLAINS MARKETING L.P. (100%)</a>
2017	12	153.09	1	<a href="#">PLAINS MARKETING L.P. (100%)</a>
2018	4	152.21	1	<a href="#">PLAINS MARKETING L.P. (100%)</a>
2018	8	164.15	1	<a href="#">PLAINS MARKETING L.P. (100%)</a>
2018	12	157.43	1	<a href="#">PLAINS MARKETING L.P. (100%)</a>
2019	5	155.54	1	<a href="#">PLAINS MARKETING L.P. (100%)</a>
2019	10	168.52	1	<a href="#">PLAINS MARKETING L.P. (100%)</a>
2020	2	161.76	1	<a href="#">PLAINS MARKETING L.P. (100%)</a>

This form shall be filed in duplicate with the Kansas Corporation Commission, 200 Colorado Derby Building, Wichita, Kansas 67202, within ten days after the completion of the well, regardless of how the well was completed.

X Attach separate letter of request if the information is to be held confidential. If confidential, only file one copy. Information on side one will be of public record and side two will then be held confidential.

Circle one: (Oil) Gas, Dry, SWD, OWVO, Injection. Type and complete ALL sections. Applications must be filed for dual completion, commingling, SWD and injection, T.A.

Attach wireline logs (i.e. electrical log, sonic log, gamma ray neutron log, etc.). KCC # (316) 263-3238. (Rules 82-2-105 & 82-2-125)

15-007-00098-00-01

OPERATOR Gould Oil Company

API NO. OWVO

ADDRESS Box 8640, 2600 N. Rock Road, Suite 200  
Wichita, KS 67208

COUNTY Barber

FIELD SUN CITY SW *U.C.*

\*\*CONTACT PERSON Dale P. Jewett  
PHONE 316 682-5523

PROD. FORMATION Fort Scott

PURCHASER Clear Creek, Inc.

LEASE Lenkner Washdown

ADDRESS P.O. Box 1045  
McPherson, KS 67460

WELL NO. #1-B

WELL LOCATION C NW SW

DRILLING Trans-Pac Drilling, Inc.  
CONTRACTOR  
ADDRESS Suite 600 - One Main Place  
Wichita, KS 67202-1399

660' Ft. from West Line and  
1980' Ft. from South Line of  
the SW/4 SEC. 4 TWP. 31S RGE. 14W *15 45*

WELL PLAT

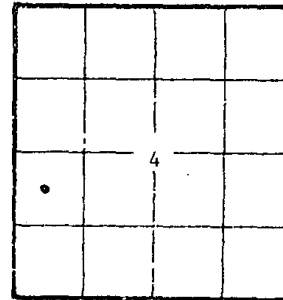

KCC ✓  
KGS ✓  
(Office Use)

PLUGGING NONE  
CONTRACTOR  
ADDRESS

TOTAL DEPTH 4865' PBD

SPUD DATE Feb. 21, 1982 DATE COMPLETED Feb. 25, 1982

ELEV: GR 1771' DF KB 1779'

DRILLED WITH (CABLE) (ROTARY) (AIR) TOOLS

Amount of surface pipe set and cemented 765' DV Tool Used? No

A F F I D A V I T

STATE OF Kansas, COUNTY OF Sedgwick SS, I, Dale P.

Jewett OF LAWFUL AGE, BEING FIRST DULY SWORN UPON HIS OATH,

DEPOSES THAT HE IS Vice President (FOR)(OF) Gould Oil, Inc.

OPERATOR OF THE Lenkner LEASE, AND IS DULY AUTHORIZED TO MAKE

THIS AFFIDAVIT AND ON THE BEHALF OF SAID OPERATOR, THAT WELL NO. #1-B ON

SAID LEASE HAS BEEN COMPLETED AS OF THE 26th DAY OF April, 19 82, AND THAT

ALL INFORMATION ENTERED HEREIN WITH RESPECT TO SAID WELL IS TRUE AND CORRECT.

CONSERVATION DIVISION  
FURTHER AFFIDAVIT NOT.  
Wichita, Kansas

(S) Dale P. Jewett

SUBSCRIBED AND SWORN BEFORE ME THIS 26th DAY OF April, 19 82.

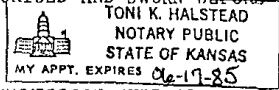

Toni K. Halstead

NOTARY PUBLIC Toni K. Halstead

MY COMMISSION EXPIRES: June 17, 1985

\*\*The person who can be reached by phone regarding any questions concerning this information. Within 45 days of completion, a witnessed initial test by the Commission is required if the well produces more than 25 BOPD or is located in a Basic Order Pool.

SIDE TWO

WELL LOG

Show all important zones of porosity and contents thereof; cored intervals, and all drill-stem tests, including depth interval tested, cushion used, time tool open, flowing and shut-in pressures, and recoveries.

SHOW GEOLOGICAL MARKERS, LOGS RUN, OR OTHER DESCRIPTIVE INFORMATION.

FORMATION DESCRIPTION, CONTENTS, ETC.	TOP	BOTTOM	NAME	DEPTH
Ran GR-N & CBL Logs.				

RELEASED  
MAR 09 1984  
FROM CONFIDENTIAL

Report of all strings set— surface, intermediate, production, etc. CASING RECORD (New) or (Used)

Purpose of string	Size hole drilled	Size casing set (in O.D.)	Weight lbs/ft.	Setting depth	Type cement	Sacks	Type and percent additives
Production		4 1/2"	10.5#	4863'	50-50 pozmix	200	18% salt 12.5 gilsonite 20 bbls. salt pre-flush.

LINER RECORD

PERFORATION RECORD

Top, ft.	Bottom, ft.	Sacks cement	Shots per ft.	Size & type	Depth interval
N/A	N/A	N/A	4	Jet	4445'-4449'

TUBING RECORD

Size	Setting depth	Packer set at
2 3/8" upset 8 rd. 1443rs	4470	N/A

ACID, FRACTURE, SHOT, CEMENT SQUEEZE RECORD

Amount and kind of material used	Depth interval treated
N/A	N/A

Date of first production 03-26-82	Producing method (flowing, pumping, gas lift, etc.) Pumping	Gravity 40°
RATE OF PRODUCTION PER 24 HOURS	Oil 57 bbls.	Gas TraceMCF
Disposition of gas (vented, used on lease or sold) Used on lease	Water %	Gas-oil ratio N/A cfbbl
Perforations 4445'-4449'		

KANSAS

**IMPORTANT**  
Kans. Geo. Survey request  
samples on this well.

**WELL COMPLETION REPORT AND  
DRILLER'S LOG**

State Geological Survey

WICHITA BRANCH

Loc. 150 NW/C NW NW

API No. 15 — 007 — 21,071  
County Number

County Barber

Operator  
Gould Oil, Inc. and LOGO, Inc.

Address  
P. O. Box 8640  
Wichita, Kansas 67208

Well No. #1 Lease Name Lenkner

Footage Location  
550 feet from (N) line 550 feet from (W) line of NW/4

Principal Contractor Eagle Drilling, Inc. Geologist Donald J. Malone

Spud Date 12/15/80 Date Completed 02/10/81 Total Depth 4900' P.B.T.D. 4565'

Directional Deviation None Oil and/or Gas Purchaser Clear Creek, Inc.

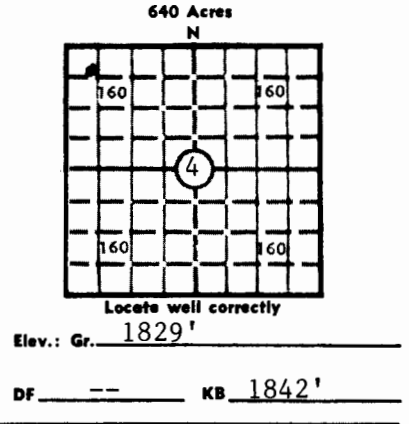

**CASING RECORD**

Report of all strings set — surface, intermediate, production, etc.

Purpose of string	Size hole drilled	Size casing set (in O.D.)	Weight lbs/ft.	Setting depth	Type cement	Sacks	Type and percent additives
Surface	12 1/4"	8 5/8"	24#	274	Common 50/50 Pozmix	250 150	3% cc + 2% gel 3% cc
Production	7 7/8"	5 1/2"	14#	4899	50/50 Pozmix	150	18% salt + 12 1/2% gel/sx + .75% CFR-2

**LINER RECORD**

**PERFORATION RECORD**

Top, ft.	Bottom, ft.	Sacks cement	Shots per ft.	Size & type	Depth interval
			4	jet	4592-96 plugged off
			4	jet	4583-87 plugged off
			4	jet	4533-36 squeezed off
			4	jet	4491-95 squeezed off
			4	jet	4492-96

**TUBING RECORD**

Size	Setting depth	Packer set at
2 3/8" EUE 8 Rd. thd.	4544'	

**ACID, FRACTURE, SHOT, CEMENT SQUEEZE RECORD**

Amount and kind of material used	Depth interval treated
250 gal. 15% MCA acid + 3000 gallons of 15% Non-E acid	4533-36 and 4491-95
150 sx of cement, squeezed to 2500#	4533-36 and 4491-95
250 gal. 15% MCA acid + 1000 gallons of 15% Non-E acid	4492-96

**INITIAL PRODUCTION**

Date of first production 02/10/81	Producing method (flowing, pumping, gas lift, etc.) Pumping
RATE OF PRODUCTION PER 24 HOURS	Oil 37 bbls. Gas -- MCF Water trace bbls. Gas-oil ratio -- CFPB
Disposition of gas (vented, used on lease or sold) --	Producing interval (s) 4492'-96'

INSTRUCTIONS: As provided in KCC Rule 82-2-125, within 90 days after completion of a well, one completed copy of this Drillers Log shall be transmitted to the State Geological Survey of Kansas, 4150 Monroe Street, Wichita, Kansas 67209. Copies of this form are available from the Conservation Division, State Corporation Commission, 245 No. Water, Wichita, Kansas 67202. Phone AC 316-522-2206. If confidential custody is desired, please note Rule 82-2-125. Drillers Logs will be on open file in the Oil and Gas Division, State Geological Survey of Kansas, Lawrence, Kansas 66044.

Operator **Gould Oil, Inc.** DESIGNATE TYPE OF COMP.: OIL, GAS, DRY HOLE, SWDW, ETC.: **Oil**

Well No. **1** Lease Name **Lenkner**

S 4 T 31 R 15 <sup>E</sup><sub>W</sub>

**WELL LOG**

Show all important zones of porosity and contents thereof; cored intervals, and all drill-stem tests, including depth interval tested, cushion used, time tool open, flowing and shut-in pressures, and recoveries.

SHOW GEOLOGICAL MARKERS, LOGS RUN, OR OTHER DESCRIPTIVE INFORMATION.

FORMATION DESCRIPTION, CONTENTS, ETC.	TOP	BOTTOM	NAME	DEPTH
<p>D.I.L. and F.D.C.-N. logs by Schlumberger G.R.-Bond logs by Viking Services</p> <p>DST #1: 4476'-4525' (30"-60"-30"-60") GTS in 18", gauged 12.7 MCFD rate in 5" of second opening and stabilized. Recovered 865' clean gassy oil + 300' heavily oil and gas cut mud. IFP = 127#-220# ISIP = 1321# FFP = 305#-373# FSIP = 1236# BHT = 115°</p> <p>DST #2: 4525'-4595', misrun, packer seat failure</p> <p>DST #3: 4516'-4595', misrun, packer seat failure</p> <p>DST #4: 4585'-4613' (30"-45"-30"-60") Rec. 120' gas in pipe + 1200' fluid as follows: 305' heavily gas cut and oil cut mud (25%-35% oil) 180' watery gas cut and oil cut mud (25%-35% oil) 180' slightly oil and gas cut water 540' slightly oil cut water IFP = 477#-498# ISIP = 570# FFP = 519#-519# FSIP = 560# (Questionable pressure data, some sample plugging of tool.)</p>				

USE ADDITIONAL SHEETS, IF NECESSARY, TO COMPLETE WELL RECORD.

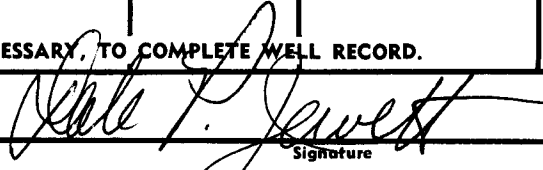
Date Received	 Signature
	Vice President Title
	February 25, 1981 Date

APPROVED FOR THE WELL  
 RECORD BY THE AGM OF THE  
 COMPANY

Med

4-31-15W  
4

DRILLER'S LOG

DUPLICATE  
DUPLICATE

State Geological Survey  
WICHITA, BRANCH

Operator: Gould Oil, Inc.  
Lease Name: LENKNER  
Spot Location: 150' NW of C NW NW  
Sec. 4 31-15W  
County, State: Barber County, Kansas

Commenced: 12-15-80  
Completed: 12-29-80

Surface Casing: 6 jts 8 5/8 new 24#, cemented with 250 sacks of common.

<u>FORMATION</u>	<u>DEPTH</u>
<u>Red Bed &amp; Rock</u>	<u>0 -274</u>
<u>Shale</u>	<u>274 -1349</u>
<u>Shale &amp; Shells</u>	<u>1349-1870</u>
<u>Shale</u>	<u>1870-2190</u>
<u>Lime &amp; Shale</u>	<u>2190-4360</u>
<u>Lime</u>	<u>4360-4613</u>
<u>Viola</u>	<u>4613</u>
<u>Lime</u>	<u>4613-4900</u>
<u>TD</u>	<u>4900</u>

I do hereby certify that the foregoing statements are true and correct to the best of my knowledge and belief.

EAGLE DRILLING, INC.  
*Robert L. Eisel*  
Robert L. Eisel

STATE OF KANSAS )  
COUNTY OF SEDGWICK ) ss:

JAN 14 1981

CONSERVATION DIVISION  
Wichita, Kansas

Subscribed and sworn to before me this 12th day of January, 1981.

My appointment expires:  
08-13-83

*Sharon M. Lewis*  
Notary Public Sharon M. Lewis

Lease: LENKNER B

Operator: Prater Oil & Gas Operations, Inc.

Location: T31S, R15W, Sec. 4

Cumulative Production: 44914.33 barrels (from 1982 to 2019)

KS Dept. of Revenue Lease Code: 119001

KS Dept. of Revenue Lease Name: LENKNER B

Adjust the Years Displayed

Start Year: 1982

End Year: 2019

Adjust Plot

Initial production monthly rate (Qi): 69 bbls in 2016

Present production monthly rate (Qt): 54 bbls in 2018

Decline rate (De): 10.8748% per year

Exponential K: .01021906

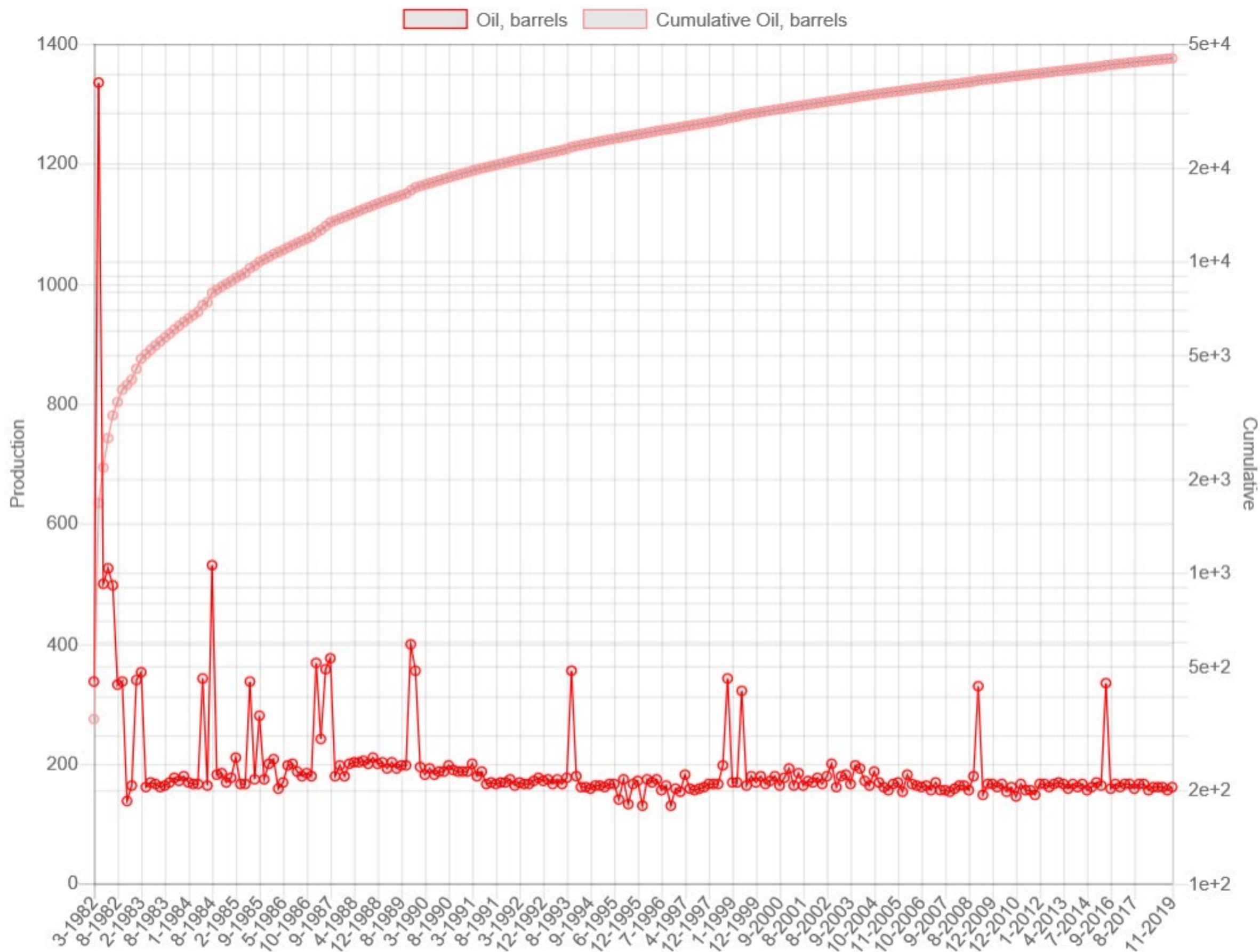



Lease: LENKNER B

Operator: Prater Oil & Gas Operations, Inc.

Location: T31S, R15W, Sec. 4

Cumulative Production: 44914.33 barrels (from 1982 to 2019)

KS Dept. of Revenue Lease Code: 119001

KS Dept. of Revenue Lease Name: LENKNER B

[View T1 PDF \(from KCC\)](#)

Field: [Sun City Southwest](#)

County: Barber

Producing Zone:

Well Data (may be an incomplete list):

<a href="#">T31S R15W, Sec. 4, SE NW NW</a> Lease: Lenkner 1 Operator: Gould Oil Inc. and Logo, Inc. Current Operator: Prater Oil & Gas Operations, Inc. API Number: 15-007-21071	<a href="#">T31S R15W, Sec. 4, NW SW</a> Lease: Lenkner 'B' 1 Operator: Gould Oil Co. Current Operator: Prater Oil & Gas Operations, Inc. API Number: 15-007-00098-0001
---	---

Data are received monthly from the Kansas Department of Revenue.

### Annual Oil Production, (bbls)

Please Note: New Prototype charting system.

Year	Production	Wells
<b>Production Charts</b> <a href="#">Prototype Chart System</a> <a href="#">Flash Chart</a> Note: Flash is no longer supported by most browsers, but may work in Microsoft Edge and Firefox. If the blue loading box does not go away in a few seconds, refresh the page.		
1982	4,171	1
1983	2,209	1
1984	2,074	1
1985	1,682	1
1986	1,861	1
1987	1,718	1
1988	1,600	1
1989	1,939	1
1990	1,885	1
1991	1,592	1
1992	1,355	1
1993	856	1
1994	1,341	1
1995	1,275	1
1996	1,254	2
1997	1,135	2
1998	872	2
1999	1,166	2
2000	1,036	2
2001	873	2

2002	895	2
2003	885	2
2004	710	2
2005	825	2
2006	988	2
2007	788	2
2008	643	2
2009	987	2
2010	787	2
2011	625	2
2012	657	2
2013	658	2
2014	642	2
2015	169	2
2016	823	2
2017	816	2
2018	644	2
2019	479	2

Updated through 11-2019.  
Note: bbls is barrels; mcf is 1000 cubic feet.

### Recent Monthly Oil Production, (bbls)

(Complete production available in file saved  
using blue button at top of page.)

Year	Month	Production	Wells	Reporter or Purchaser/ Reporting Customer
2014	1	159.66	2	<a href="#">High Sierra Crude Oil &amp; Marketing, LLC (100%)</a>
2014	4	164.67	2	<a href="#">High Sierra Crude Oil &amp; Marketing, LLC (100%)</a>
2014	7	157.21	2	<a href="#">High Sierra Crude Oil &amp; Marketing, LLC (100%)</a>
2014	9	160.93	2	<a href="#">NGL CRUDE LOGISTICS, LLC (100%)</a>
2015	1	168.61	2	<a href="#">NGL CRUDE LOGISTICS, LLC (100%)</a>
2016	6	163.5	2	<a href="#">NGL CRUDE LOGISTICS, LLC (100%)</a>
2016	7	334.29	2	<a href="#">NGL CRUDE LOGISTICS, LLC (100%)</a>
2016	9	158.18	2	<a href="#">NGL CRUDE LOGISTICS, LLC (100%)</a>
2016	11	167.15	2	<a href="#">NGL CRUDE LOGISTICS, LLC (100%)</a>
2017	1	159.66	2	<a href="#">NGL CRUDE LOGISTICS, LLC (100%)</a>
2017	3	165.71	2	<a href="#">NGL CRUDE LOGISTICS, LLC (100%)</a>
2017	6	166.73	2	<a href="#">NGL CRUDE LOGISTICS, LLC (100%)</a>
2017	8	158.83	2	<a href="#">NGL CRUDE LOGISTICS, LLC (100%)</a>
2017	11	164.74	2	<a href="#">NGL CRUDE LOGISTICS, LLC (100%)</a>
2018	2	166.89	2	<a href="#">NGL CRUDE LOGISTICS, LLC (100%)</a>
2018	5	154.96	2	<a href="#">NGL CRUDE LOGISTICS, LLC (100%)</a>
2018	9	160.05	2	<a href="#">NGL CRUDE LOGISTICS, LLC (100%)</a>
2018	12	162	2	<a href="#">NGL CRUDE LOGISTICS, LLC (100%)</a>
2019	5	162.3	2	<a href="#">NGL CRUDE LOGISTICS, LLC (100%)</a>
2019	9	156.25	2	<a href="#">M V Purchasing LLC (100%)</a>
2019	11	160.64	2	<a href="#">M V Purchasing LLC (100%)</a>